

SCHEDULE 40 BRASS NIPPLES & READY CUT PIPE

MATERIAL SPECIFICATIONS:

- ASTM B43 Brass Pipe
- C23000 No Lead Red Brass

DIMENSIONAL SPECIFICATIONS:

- ASTM B43 Brass Pipe
- ASTM B687 Pipe Nipples

THREAD SPECIFICATIONS:

- ANSI/ASME B1.20.1 Pipe Threads

CERTIFICATION:

- NSF/ANSI 61 & 372

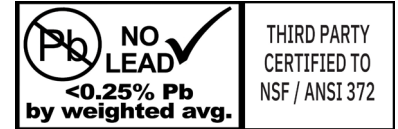

BOSHART
INDUSTRIES

25 Whaley Avenue, PO Box 310, Milverton, ON CANADA N0K 1M0
Tel: 800-561-3164

boshart.com ♦ blog.boshart.com

© 2020 Boshart Industries Inc. All Rights Reserved.

BII-BRN-0822(1202BR)

BRASS NIPPLES & READY CUT PIPE

Schedule 40 Red Brass Pipe Size

| Pipe Size | OD | | Wall Thickness | |
|-----------|--------|------|----------------|------|
| | Inches | mm | Inches | mm |
| 1/8" | 0.405 | 10.3 | 0.062 | 1.57 |
| 1/4" | 0.54 | 13.7 | 0.082 | 2.08 |
| 3/8" | 0.675 | 17.1 | 0.09 | 2.29 |
| 1/2" | 0.84 | 21.3 | 0.107 | 2.72 |
| 3/4" | 1.05 | 26.7 | 0.114 | 2.9 |
| 1" | 1.315 | 33.4 | 0.126 | 3.2 |
| 1-1/4" | 1.66 | 42.2 | 0.146 | 3.71 |
| 1-1/2" | 1.9 | 48.3 | 0.15 | 3.81 |
| 2" | 2.375 | 60.3 | 0.156 | 3.96 |
| 2-1/2" | 2.875 | 73 | 0.187 | 4.75 |
| 3" | 3.5 | 88.9 | 0.219 | 5.56 |
| 4" | 4.5 | 114 | 0.25 | 6.35 |



Nipples with lengths up through 12 in. (305 mm) long shall have a length tolerance of $\pm 1/16$ in. (1.6mm). Nipples over 12 in. long are refer to as ready cut pipe and have a tolerance of $\pm 1/8$ in.(3.2 mm) as defined in ASTM B687.

Close Nipple-NPT

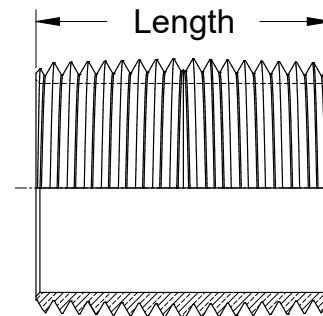
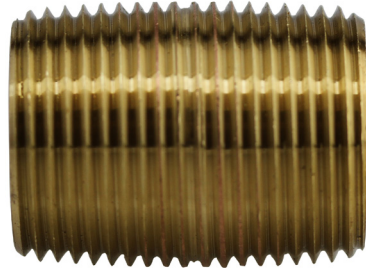

| | | | | | | | | | | | | |
|-----------|--------|--------|--------|--------|--------|--------|--------|--------|--------|--------|--------|--------|
| Pipe Size | 1/8" | 1/4" | 3/8" | 1/2" | 3/4" | 1" | 1-1/4" | 1-1/2" | 2" | 2-1/2" | 3" | 4" |
| Part No. | BRN-01 | BRN-02 | BRN-03 | BRN-05 | BRN-07 | BRN-10 | BRN-12 | BRN-15 | BRN-20 | BRN-25 | BRN-30 | BRN-40 |
| Length | 3/4" | 7/8" | 1" | 1-1/8" | 1-3/8" | 1-1/2" | 1-5/8" | 1-3/4" | 2" | 2-1/2" | 2-5/8" | 2-7/8" |

BOSHART
INDUSTRIES

© 2020 Boshart Industries Inc. All Rights Reserved.

25 Whaley Avenue, PO Box 310, Milverton, ON CANADA N0K 1M0
Tel: 800-561-3164

boshart.com ♦ blog.boshart.com

BRASS NIPPLES & READY CUT PIPE

Shoulder Nipple-NPT

Shoulder nipples are longer than a close nipple and include a very short unthreaded space between the threads. The unthreaded space is not large enough to fit a pipe wrench. When two female fittings are screwed onto either end, a small piece of nipple will remain exposed. A shoulder nipple is the first length of nipple that is available up from a close nipple.

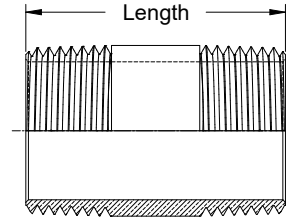
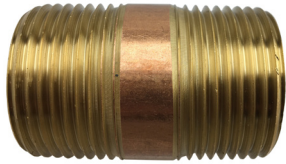

Pipe Nipple-NPT

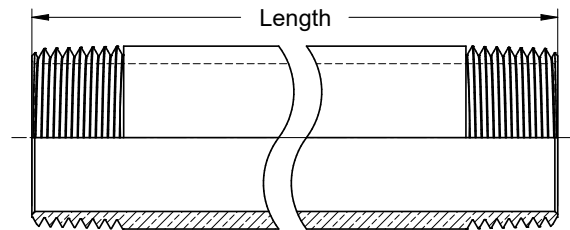

| Pipe Size Length | 1/8" | 1/4" | 3/8" | 1/2" | 3/4" | 1" | 1-1/4" |
|---------------------|-----------|-----------|-----------|-------------|-------------|-------------|-------------|
| 1-1/2" | BRN-0115 | BRN-0215 | BRN-0315 | BRN-0515 | BRN-0715 | | |
| 2" | BRN-0120 | BRN-0220 | BRN-0320 | BRN-0520 | BRN-0720 | BRN-1020 | BRN-1220 |
| 2-1/2" | BRN-0125 | BRN-0225 | BRN-0325 | BRN-0525 | BRN-0725 | BRN-1025 | BRN-1225 |
| 3" | BRN-0130 | BRN-0230 | BRN-0330 | BRN-0530 | BRN-0730 | BRN-1030 | BRN-1230 |
| 3-1/2" | BRN-0135 | BRN-0235 | BRN-0335 | BRN-0535 | BRN-0735 | BRN-1035 | BRN-1235 |
| 4" | BRN-0140 | BRN-0240 | BRN-0340 | BRN-0540 | BRN-0740 | BRN-1040 | BRN-1240 |
| 4-1/2" | BRN-0145 | BRN-0245 | BRN-0345 | BRN-0545 | BRN-0745 | BRN-1045 | BRN-1245 |
| 5" | BRN-0150 | BRN-0250 | BRN-0350 | BRN-0550 | BRN-0750 | BRN-1050 | BRN-1250 |
| 5-1/2" | BRN-0155 | BRN-0255 | BRN-0355 | BRN-0555 | BRN-0755 | BRN-1055 | BRN-1255 |
| 6" | BRN-0160 | BRN-0260 | BRN-0360 | BRN-0560 | BRN-0760 | BRN-1060 | BRN-1260 |
| 7" | BRN-0170 | BRN-0270 | BRN-0370 | BRN-0570 | BRN-0770 | BRN-1070 | |
| 8" | BRN-0180 | BRN-0280 | BRN-0380 | BRN-0580 | BRN-0780 | BRN-1080 | BRN-1280 |
| 9" | BRN-0190 | BRN-0290 | BRN-0390 | BRN-0590 | BRN-0790 | BRN-1090 | BRN-1290 |
| 10" | BRN-01100 | BRN-02100 | BRN-03100 | BRN-05100 | BRN-07100 | BRN-10100 | BRN-12100 |
| 11" | | | | | | BRN-10110 | |
| 12" | BRN-01120 | BRN-02120 | BRN-03120 | BRN-05120 | BRN-07120 | BRN-10120 | BRN-12120 |
| Ready Cut Pipe | | | | | | | |
| 18" | | | | BRRCP-05180 | BRRCP-07180 | BRRCP-10180 | BRRCP-12180 |
| 24" | | | | BRRCP-05240 | BRRCP-07240 | BRRCP-10240 | BRRCP-12240 |
| 30" | | | | BRRCP-05300 | BRRCP-07300 | BRRCP-10300 | BRRCP-12300 |
| 36" | | | | BRRCP-05360 | BRRCP-07360 | BRRCP-10360 | BRRCP-12360 |



25 Whaley Avenue, PO Box 310, Milverton, ON CANADA N0K 1M0
Tel: 800-561-3164

boshart.com ♦ blog.boshart.com

BRASS NIPPLES & READY CUT PIPE

Pipe Nipple-NPT

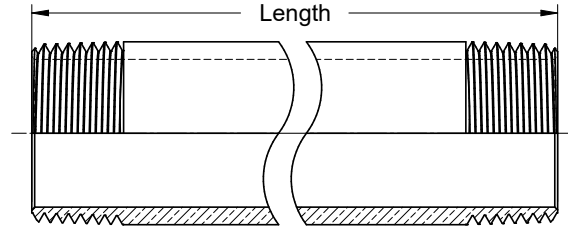

| Pipe Size \ Length | 1-1/2" | 2" | 2-1/2" | 3" | 4" |
|--------------------|-------------|-------------|-----------|-----------|-----------|
| 2" | BRN-1520 | | | | |
| 2-1/2" | BRN-1525 | BRN-2025 | | | |
| 3" | BRN-1530 | BRN-2030 | BRN-2530 | BRN-3030 | |
| 3-1/2" | BRN-1535 | BRN-2035 | BRN-2535 | BRN-3035 | BRN-4035 |
| 4" | BRN-1540 | BRN-2040 | BRN-2540 | BRN-3040 | BRN-4040 |
| 4-1/2" | BRN-1545 | BRN-2045 | BRN-2545 | BRN-3045 | BRN-4045 |
| 5" | BRN-1550 | BRN-2050 | BRN-2550 | BRN-3050 | BRN-4050 |
| 5-1/2" | BRN-1555 | BRN-2055 | BRN-2555 | BRN-3055 | |
| 6" | BRN-1560 | BRN-2060 | BRN-2560 | BRN-3060 | BRN-4060 |
| 7" | | BRN-2070 | | | |
| 8" | BRN-1580 | BRN-2080 | BRN-2580 | BRN-3080 | BRN-4080 |
| 9" | | BRN-2090 | | | |
| 10" | BRN-15100 | BRN-20100 | BRN-25100 | BRN-30100 | |
| 11" | | | | | |
| 12" | BRN-15120 | BRN-20120 | BRN-25120 | BRN-30120 | BRN-40120 |
| Ready Cut Pipe | | | | | |
| 18" | BRRCP-15180 | BRRCP-20180 | | | |
| 24" | BRRCP-15240 | BRRCP-20240 | | | |
| 30" | BRRCP-15300 | BRRCP-20300 | | | |
| 36" | BRRCP-15360 | BRRCP-20360 | | | |
| 48" | | BRRCP-20480 | | | |